

Real Estate Information



This database was last updated on 6/19/2019 at 9:22 PM

[Return to County Website](#) | [Log Out](#)

Parcel Details for 008-291-11-0-20-12-010.00-0 - Printer Friendly Version

Quick Reference #: r15718

Owner Information ✖	
Owner's Name (Primary):	HARVEY, DARRELL E & BARBARA J; TOD
Mailing Address:	13 E Ranchwood Dr Augusta, KS 67010-2311
Property Address ✖	
Address:	13 E Ranchwood Dr Augusta, KS 67010
General Property Information ✖	
Property Class:	Residential - R
Living Units:	1
Zoning:	
Neighborhood:	281
Taxing Unit:	002
Deed Information ✖	
Document #	Document Link
2015-9291	View Deed Information
D338-0014	View Deed Information

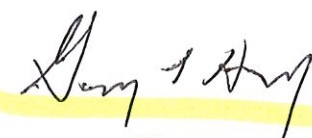
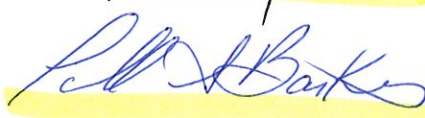
Residential Information

Building #: 1

Dwelling Information

Residence Type: Residential/Agricultural - 1
 Quality: AV
 Year Built: 1977
 Effective Year:
 MS Style: 1
 LBCS Structure: Detached SFR unit
 # of Units:
 Total Living Area:
 Calculated Area: 1,248
 Main Floor LA: 1,248
 Upper Floor LA %:
 CDU: AV
 Phys / Func / Econ: AV / N/A / N/A
 Ovr % Good / RCN: /
 Remodel:
 % Complete:
 Assessment Class:
 MU Class #1 / %: / MU Class #2 / %: / MU Class #3 / %: /

Component Sales Information

Architectural Style: Ranch
 Basement Type: Full - 4
 Total Rooms: 6
 Bedrooms: 3
 Family Rooms: 1
 Full Baths: 2
 Half Baths: 1
 Garage Capacity: 2 car
 Foundation: Concrete - 2

Residential Components

Code / Description	Units	Percentage	Quality	Year
Enclosed Wood Deck (SF), Solid Wall	216			
Attached Garage (SF)	624			
Garage Finish, Attached (SF)	624			
Raised Slab Porch (SF) with Roof	144			
Veneer, Brick		75		
Composition Shingle		100		
Total Basement Area (SF)	1,248			
Raised Subfloor (% or SF)	1,248			
Minimal Finish Area (SF)	672			
Warmed & Cooled Air		100		
Plumbing Fixtures (#)	10			
Plumbing Rough-ins (#)	1			
Single 1-Story Fireplace (#)	1			
Automatic Floor Cover Allowance				
Frame, Siding, Vinyl		25		

Residential Information

Building #: 1 Sketch Vector

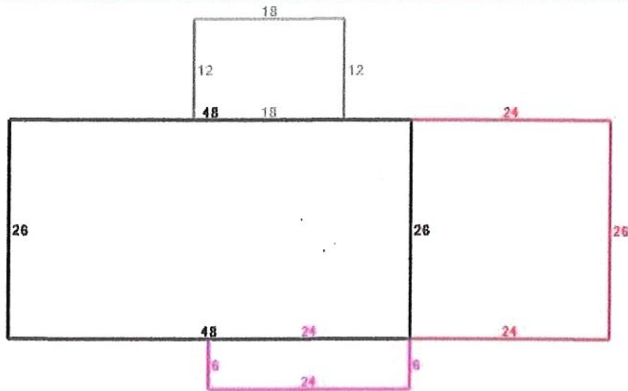

Handwritten signatures and notes:
 Aug 7 Aug
 P. Banks

Black = Original
Gray = Enclosed Wood Deck (SF), Solid Wall 1
Red = Attached Garage (SF) 2
Fuchsia = Raised Slab Porch (SF) with Roof 3

Commercial Information [Information Not Available]

Other Building Improvement Information

Occup	MS Class	Rank	Quantity	Year Built	Effective Year	LBCS	Area	Perim	Hgt	Dimensions		Phys	Cond	Func	Econ	Ovr %	Reason	RCN LD	% Good	MS Value
										(L x W)	Stories									
Prefabricated Storage Shed	D	GD	1	1990			120	44	6	12 x 10	1	AV	AV					190	7	190

Code	Units	Percentage %	Area	Other	Rank	Year
------	-------	--------------	------	-------	------	------

Agricultural Information [Information Not Available]

This parcel record was last updated on 7/8/2019 at 6 am.



Neighborhood / Tract Information	
Neighborhood:	281 Lot: 7
Tract:	Section: 11 Township: 27 Range: 04E
Tract Description:	LAKESIDE NO 2 1ST ADD, S11, T27, R04E, Lot 7
Acres:	0.50
Market Acres:	0.50

Land Based Classification System	
Function:	Single family residence (detached)
Activity:	Household activities
Ownership:	Private-fee simple
Site:	Developed site - with buildings

Property Factors			
Topography:	Level - 1	Parking Type:	On and Off Street - 3
Utilities:	All Public - 1	Parking Quantity:	Adequate - 2
Access:	Paved Road - 1	Parking Proximity:	On Site - 3
Fronting:	Residential Street - 4	Parking Covered:	
Location:	Neighborhood or Spot - 6	Parking Uncovered:	

Appraised Values				
Tax Year	Property Class	Land	Building	Total
2019	Residential - R	15,750	120,850	136,600
2018	Residential - R	15,750	117,250	133,000

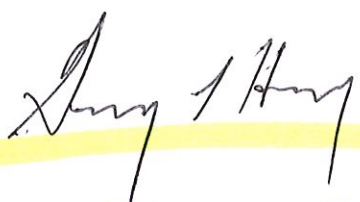
Market Land Information					
Type	Method	Area or Acres	Eff. Frontage	Eff. Depth	Est. Value
Regular Lot - 1	Acre	0.50			00
Influence #1:		Influence #2:		Influence Override:	
Factor:		Factor:		Depth Factor:	

PROPERTY TAX INFORMATION



[Return To County Website](#)

[Logout](#)

Current Tax Information

Type RL **CAMA Number** 291 11 0 20 12 010 00 0 **Tax Identification** 002-2751000
Owner ID HARV00038 HARVEY, DARRELL E & BARBARA J
Taxpayer ID HARV00038 HARVEY, DARRELL E & BARBARA J
 13 E RANCHWOOD 67010-
Subdivision LAKESIDE NO 2 **Block** **Lot(s)** 7 **Section** 11 **Township** 27 **Range** 04
 1ST ADD

[Tax History](#)
[Current Real Estate Detail](#)
[GIS Map](#)
[Print Friendly Version](#)

Year	Statement #	Line #	Warrant #	Specials Description	Specials Payoff	1st Half Due	2nd Half Due	Total Due*	1st Half Paid	2nd Half Paid
<u>2018</u>	0031600	001			0.00	1,308.95	1,308.95	0.00	Yes	Yes

Click on underlined tax year to see payment detail and where the tax dollars go.

* - Does not include interest, penalties and fees.

For delinquent tax pay off amount contact Butler County Treasurer 205 W. Central Ave, El Dorado, KS 67042, (316) 322-4210

Gregory H. Hry

Paula A. Banks

[Back To Search Results](#)

[Back To Search Criteria](#)