



This database was last updated on 2/19/2020 at 9:23 PM

[Return to County Website](#) | [Log Out](#)
[New Search](#) | [Back to Results](#)

Parcel Details for 008-167-35-0-20-03-002.00-0

[View GIS Map](#) | [View Tax Detail](#)

Page 1 of 1



Owner Information	Property Address
Owner's Name (Primary): NELSON FAMILY REV INTER VIVOS TRUST	Address: 1509 N Main St El Dorado, KS 67042

General Property Information	Deed Information
	Document Document Link #

Neighborhood / Tract Information	
Neighborhood:	121
Tract:	Section: 35 Township: 25 Range: 05E
Tract Description:	S35, T25, R05E, ACRES 8.6, PT N1/2 NW1/4 LYG S & E W BRANCH WALNUT RIV & W AT&SF RR ROW; BEG INTER W RR R/W & N LN SE1/4 NW1/4 SELY223.76 W1005 TO CTR LN RIV

Land Based Classification System	
Function:	Farming / ranch operation (with improvements)
Activity:	Farming, plowing, tilling, harvesting, or related activities
Ownership:	Private-fee simple
Site:	Dev Site - crops, grazing etc - with structures

Property Factors			
Topography:	Level - 1	Parking Type:	Off Street - 1
Utilities:	All Public - 1	Parking Quantity:	Adequate - 2
Access:	Paved Road - 1	Parking Proximity:	On Site - 3
Fronting:	Residential Street - 4	Parking Covered:	
Location:	Neighborhood or Spot - 6	Parking Uncovered:	

Appraised Values				
Tax Year	Property Class	Land	Building	Total
2019	Farm Homesite - F	21,100	52,300	73,400
2019	Agricultural Use - A	1,750	00	1,750

Market Land Information					
Type	Method	Area or Acres	Eff. Frontage	Eff. Depth	Est. Value

Regular Lot - 1 Acre 1.40 00
 Influence #1: Influence #2: Influence Override:
 Factor Factor Depth Factor

Residential Information ↗

Building #: 1

[View Sketch Vector](#)

Dwelling Information

Residence Type: Residential/Agricultural - 1
 Quality: AV-
 Year Built: 1936
 Effective Year:
 MS Style: 1
 LBCS Structure: Detached SFR unit
 # of Units:
 Total Living Area:
 Calculated Area: 1,065
 Main Floor LA: 1,065
 Upper Floor LA %:
 CDU: FR
 Phys / Func / Econ: FR / N/A / N/A
 Ovr % Good / RCN: /
 Remodel:
 % Complete:
 Assessment Class:

Component Sales Information

Architectural Style: Cottage
 Basement Type: Crawl - 2
 Total Rooms: 4
 Bedrooms: 2
 Family Rooms:
 Full Baths: 1
 Half Baths:
 Garage Capacity:
 Foundation: Stone - 4

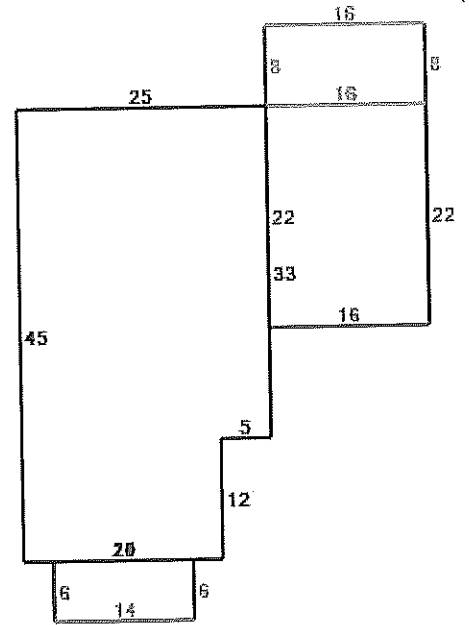

Black = Original
 Gray = Slab Porch (SF) w/ Roof
 Red = Enclosed Porch (SF)
 Fuchsia = Raised Slab Porch (SF)

MU Class #1 / %: / MU Class #2 / %: / MU Class #3 / %: /

Residential Components

Code / Description	Units	Percentage	Quality	Year
Frame, Plywood or Hardboard		100		
Composition Shingle		100		
Warmed & Cooled Air		100		
Automatic Floor Cover Allowance				
Plumbing Fixtures (#)	6			
Plumbing Rough-ins (#)	1			
Raised Subfloor (% or SF)	1,065			
Slab Porch (SF) with Roof	128			
Enclosed Porch (SF), Knee Walls w/ Glass	352			
Raised Slab Porch (SF) with Roof	84			

Commercial Information [Information Not Available] ↗

Other Building Improvement Information ↗

MS	Occup Class	Rank	Quantity	Year Effective	Year	Dimensions			Phys	Ovr	Ovr	RCN	% LD	MS
						L	W	Hgt						
Residential	D	AV	1	1983	1250	99	10	1	FR	AV		27900	11	3070
Garage - Detached														
Components														

Code	Code Description	Units	Percentage %	Area	Other	Rank	Year
Residential Garage - Detached	D AV 1 1983	1340 156 8	1	FR AV		28462 11	3130
Components							
Code	Code Description	Units	Percentage %	Area	Other	Rank	Year
Prefabricated Storage Shed	D AV 1 2000	120 46 8	8 x 15	1 AV AV		2256 7	160
Components							
Code	Code Description	Units	Percentage %	Area	Other	Rank	Year
Outbuildings	D AV 1 1985	10	8	1 AV AV		6033 24	1450
Components							
Code	Code Description	Units	Percentage %	Area	Other	Rank	Year
8025		1					

Agricultural Information			
Agricultural Land			
Land Type:	Dry Land - DR	Irrig. Type:	Adjust Code:
Acres:	1.60	Well Depth:	Govt. Prgm:
Soil Unit:	8302	Acre Feet:	Base Rate: 524
		Acre Feet/Ac:	Adjust Rate: 524
Land Type:	Native Grass - NG	Irrig. Type:	Adjust Code:
Acres:	5.70	Well Depth:	Govt. Prgm:
Soil Unit:	8302	Acre Feet:	Base Rate: 173
		Acre Feet/Ac:	Adjust Rate: 173
Agricultural Land Summary			
Dry Land - DR Acres:	1.60	Total Land Acres:	7.30
Native Grass - NG Acres:	5.70	Total Land Use Value:	1,830
		Total Land Mkt Value:	42,720



PROPERTY TAX INFORMATION



[Return To County Website](#)

[Logout](#)

Current Tax Information

Type CAMA Number Tax Identification
 RL 167 35 0 20 03 002 00 0 01 007-4481000
 Owner ID NELS00167NELSON FAMILY REV INTER VIVOS TRUST
 Taxpayer ID NELS00167NELSON FAMILY REV INTER VIVOS TRUST

[Tax History](#)
[Current Real Estate Detail](#)
[GIS Map](#)
[Print Friendly Version](#)

1509 N MAIN 67042
 Subdivision Block Lot(s) Section 35 Township 25 Range 05

Year	Statement #	Line #	Warrant #	Specials Description	Specials Payoff	1st Half Due	2nd Half Due	Total Due*	1st Half Paid	2nd Half Paid
2019	0050210	001			0.00	756.62	756.62	756.62	Yes	No
2019	0050210	002		<u>STORMWATER UTILITY</u>	18.00	18.00	18.00	18.00	Yes	No

Click on underlined tax year to see payment detail and where the tax dollars go.

* - Does not include all interest, penalties and fees.

For delinquent tax pay off amount contact Butler County Treasurer 205 W. Central Ave, El Dorado, KS 67042, (316) 322-4210

[Back To Search Results](#)

[Back To Search Criteria](#)