



This database was last updated on 9/26/2020 at 9:23 PM

[Return to County Website](#) | [Log Out](#)

[New Search](#) | [Back to Results](#)

**Parcel Details for 008-295-22-0-40-04-006.00-0**

[View GIS Map](#) | [View Tax Detail](#)

Page 1 of 1



Owner Information	Property Address
<b>Owner's Name (Primary):</b> ILSLEY, CHARLES S	<b>Address:</b> 1140 N Osage St Augusta, KS 67010

General Property Information	Deed Information
<b>Property Class:</b> Residential - R <b>Living Units:</b> 1 <b>Zoning:</b> <b>Neighborhood:</b> 231	<b>Document Document Link #</b> 0927- <a href="#">View Deed Information</a> 0216 0619- <a href="#">View Deed Information</a>

Neighborhood / Tract Information
<b>Neighborhood:</b> 231 Block: 2 Lot: 21; S/2 22 <b>Tract:</b> Section: 22 Township: 27 Range: 04E <b>Tract Description:</b> SISCO & GOODS ADD, S22, T27, R04E, BLOCK 2, Lot 21; S/2 22

Land Based Classification System
<b>Function:</b> Single family residence (detached) <b>Activity:</b> Household activities <b>Ownership:</b> Private-fee simple <b>Site:</b> Developed site - with buildings

Property Factors
<b>Topography:</b> Level - 1 <b>Utilities:</b> All Public - 1 <b>Access:</b> Paved Road - 1; Alley - 7 <b>Fronting:</b> Residential Street - 4 <b>Location:</b> Neighborhood or Spot - 6 <b>Parking Type:</b> On and Off Street - 3 <b>Parking Quantity:</b> Adequate - 2 <b>Parking Proximity:</b> On Site - 3 <b>Parking Covered:</b> <b>Parking Uncovered:</b>

Appraised Values				
Tax Year	Property Class	Land	Building	Total
2020	Residential - R	6,760	29,970	36,730
2019	Residential - R	6,760	29,970	36,730

Market Land Information ⏏

Type	Method	Area or Acres	Eff. Frontage	Eff. Depth	Est. Value
Regular Lot - 1	Sqft	4688.00			6,757
Influence #1: Factor:		Influence #2: Factor:		Influence Override: Depth Factor:	

Residential Information ⏏

**Building #: 1**

**Dwelling Information**

Residence Type:  
Residential/Agricultural - 1  
Quality: FR+  
Year Built: 1920  
Effective Year:  
MS Style: 1  
LBCS Structure:  
Detached SFR unit  
# of Units:  
Total Living Area:  
Calculated Area: 1,150  
Main Floor LA: 1,150  
Upper Floor LA %:  
CDU: FR-  
Phys / Func / Econ: FR / N/A / N/A  
Ovr % Good / RCN: /  
Remodel:  
% Complete:  
Assessment Class:

**Component Sales Information**

Architectural Style: Old Style  
Basement Type: Crawl - 2  
Total Rooms: 6  
Bedrooms: 3  
Family Rooms:  
Full Baths: 1  
Half Baths:  
Garage Capacity:  
Foundation: Concrete - 2

[View Sketch Vector](#)

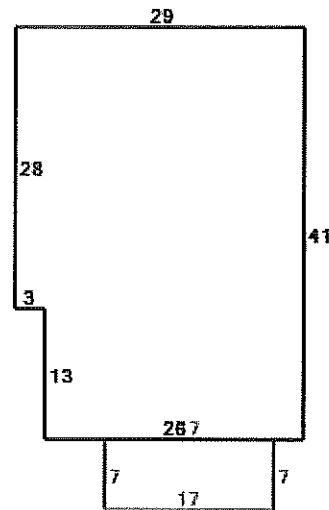

**Black = Original**  
**Gray = Raised Slab Porch**

MU Class #1 / %: / MU Class #2 / %: / MU Class #3 / %: /

**Residential Components**

Code / Description	Units	Percentage	Quality	Year
Raised Slab Porch with Roof	119			
Frame, Siding/Shingle		100		
Composition Shingle		100		
Raised Subfloor	1,150			
Plumbing Fixtures	7			
Plumbing Rough-ins	1			
Automatic Floor Cover Allowance				
Forced Air Furnace		100		

Commercial Information [Information Not Available] ⏏

Other Building Improvement Information ⏏

MS	Year Effective	Dimensions			Phys	Ovr	Ovr	RCN	%	MS									
Occup	Class	Rank	Quantity	Built	Year	LBCS	Area	Perim	Hgt	(L x W)	Stories	Cond	Func	Econ	%	Reason	LD	Good	Value
Residential	Garage	D	FR	1	1940		280	68	8	20 x 1	1	FR	FR			7386	10	740	
- Detached																			
										14									

**Components**

Code	Code Description	Units	Percentage %	Area	Other	Rank	Year
------	------------------	-------	--------------	------	-------	------	------

Agricultural Information [Information Not Available] ⏏