

Real Estate Information



This database was last updated on 3/6/2023 at 8:08 PM

[Return to County Website](#) | [Log Out](#)

Parcel Details for 008-307-25-0-00-001.00-0 - Printer Friendly Version

Owner Information ✕	
Owner's Name (Primary):	SUDDUTH, JACKIE W & ROSE MARIE; TOD
Mailing Address:	204 W Murdock St Andover, KS 67002-9748
Property Address ✕	
Address:	11019 SW Highway 54 Augusta, KS 67010
General Property Information ✕	
Property Class:	Commercial & Industrial - C
Living Units:	1
Zoning:	
Neighborhood:	507.5
Taxing Unit:	139
Deed Information ✕	
Document #	Document Link
2015-7490	View Deed Information
D356-0202	View Deed Information

Neighborhood / Tract Information

Neighborhood: 507.5
Tract: Section: 25 Township: 27 Range: 03E
Tract Description: S25, T27, R03E, ACRES 1, BEG 30W & 30S NE/C NE4 S276.96 W127 N79.12 W99 N198 E255.44 TO POB LESS ROW (SCALED)

Land Based Classification System

Function: General sales or services (nec)
Activity: Shopping, business, trade activities
Ownership: Private-fee simple
Site: Developed site - with buildings

Property Factors

Topography:	Level - 1	Parking Type:	Off Street - 1
Utilities:	All Public - 1	Parking Quantity:	Adequate - 2
Access:	Paved Road - 1	Parking Proximity:	On Site - 3
Fronting:	Secondary Artery - 2	Parking Covered:	
Location:	Neighborhood or Spot - 6	Parking Uncovered:	

Appraised Values

Tax Year	Property Class	Land	Building	Total
2023	Residential - R	17,250	22,360	39,610
2023	Commercial & Industrial - C	40,250	16,080	56,330
2022	Residential - R	17,250	19,280	36,530
2022	Commercial & Industrial - C	40,250	16,000	56,250
2021	Residential - R	16,380	18,390	34,770
2021	Commercial & Industrial - C	38,220	15,610	53,830
2020	Residential - R	16,380	18,390	34,770
2020	Commercial & Industrial - C	38,220	16,200	54,420

Market Land Information

Type	Method	Area or Acres	Eff. Frontage	Eff. Depth	Est. Value
Regular Lot - 1	Acre	1.00			40,250
Influence #1:		Influence #2:		Influence Override:	
Factor:		Factor:		Depth Factor:	
Regular Lot - 1	Acre	1.00			17,250
Influence #1:		Influence #2:		Influence Override:	
Factor:		Factor:		Depth Factor:	



Building #: 1

Dwelling Information

Residence Type: Residential/Agricultural - 1
 Quality: FR+
 Year Built: 1949
 Effective Year:
 MS Style: 1
 LBCS Structure: Detached SFR unit
 # of Units:
 Total Living Area:
 Calculated Area: 686
 Main Floor LA: 686
 Upper Floor LA %:
 CDU: PR
 Phys / Func / Econ: AV / N/A / N/A
 Ovr % Good / RCN: /
 Remodel:
 % Complete:
 Assessment Class: Residential
 MU Class #1 / %: / MU Class #2 / %: / MU Class #3 / %: /

Component Sales Information

Architectural Style: Cottage
 Basement Type: Crawl - 2
 Total Rooms: 3
 Bedrooms: 1
 Family Rooms:
 Full Baths: 1
 Half Baths:
 Garage Capacity:
 Foundation: Concrete - 2

Residential Components

Code / Description	Units	Percentage	Quality	Year
Frame, Siding, Wood		100		
Composition Shingle		100		
Wall Furnace		100		
Automatic Floor Cover Allowance				
Plumbing Fixtures	5			
Raised Subfloor	576			
Slab on Grade	110			
Plumbing Rough-ins	1			
Open Slab Porch	25			
Open Slab Porch	24			



Building #: 1 Sketch Vector

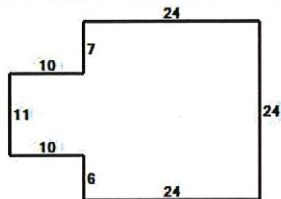

Black = Original



Building #: 1

Building Information

LBCS Structure Code: Standalone store or shop building
 Building Name: NEW BEGINNINGS SALON
 Identical Units: 1
 # of Units:
 Unit Type:
 MS Mult:
 MS Zip Code:

Apartment Information

Units	BR Type	Baths
Apartment #1:		
Apartment #2:		
Apartment #3:		
Apartment #4:		
Apartment #5:		
Apartment #6:		
Apartment #7:		
Apartment #8:		

[View Sketch Vector](#)

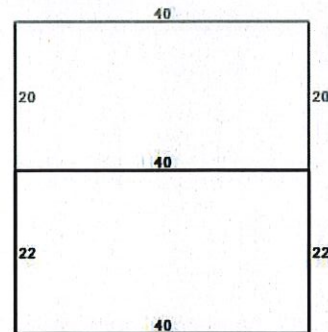

Black = Original
Gray = Addition 1

Building Sections & Basements

#	MS	Year	Effective	Phys	Ovr	Ovr	Depr	%	MS											
Occup	Class	Rank	Built	Year	Levels	Stories	Area	Perim	Hgt	Cond	Func	Econ	%	Reason	Use	Class	RCN	Good	Value	
1	Retail	FR+	1954	01 /	880	84	8	FR	FR											
	Store			01																

Section Components

Code Code Description Unit Type Units Pct % Other Rank Year Comment

812	Concrete Block	100
606	Space Heater	100
8002	Porch, Open Slab	21

2 Retail Store	FR+ 1991	01 / 01	800 80 8	FR FR	Multi-Use Sales - 083	Commercial	50,856	17	8,650
----------------	----------	---------	----------	-------	-----------------------	------------	--------	----	-------

Section Components

Code	Code Description	Unit Type	Units	Pct %	Other	Rank	Year	Comment
918		Single -Metal on Wood Frame					100	
606		Space Heater					100	

Other Building Improvement Information

Occup	MS Class	Rank	Quantity	Year Built	Effective Year	LBCS	Area	Perim	Hgt	Dimensions (L x W)	Stories	Phys Cond	Func	Econ	Ovr %	Reason	RCN LD	% Good	MS Value
Tool Shed	C	AV	1	1954			80	36	6	10 x 8	1	FR	AV				4315	4	170
Components																			
Code	Code Description						Units			Percentage %		Area		Other		Rank		Year	
649										100									
812																			
Tool Shed	D	AV	1	2016			128	48	8	16 x 8	1	FR	AV				3295	10	330
Components																			
Code	Code Description						Units			Percentage %		Area		Other		Rank		Year	
649										100									
918																			
Prefabricated Storage Shed	D	GD	1	2000			150	50	8	15 x 10	1	AV	AV				4356	7	300
Components																			
Code	Code Description						Units			Percentage %		Area		Other		Rank		Year	

Agricultural Information [Information Not Available]

This parcel record was last updated on 3/7/2023 at 6 am.

Real Estate Information



This database was last updated on 3/6/2023 at 8:08 PM

[Return to County Website](#) | [Log Out](#)

Parcel Details for 008-307-25-0-00-00-002.00-0 - Printer Friendly Version

Owner Information ✕	
Owner's Name (Primary):	SUDDUTH, JACKIE W & ROSE M; TOD
Mailing Address:	204 W Murdock St Andover, KS 67002-9748
Property Address ✕	
Address:	11063 SW Highway 54 Augusta, KS 67010
General Property Information ✕	
Property Class:	Commercial & Industrial - C
Living Units:	
Zoning:	
Neighborhood:	507.5
Taxing Unit:	139
Deed Information ✕	
Document #	Document Link
2015-7490	View Deed Information
0774-0140	View Deed Information
D350-0387	View Deed Information

Neighborhood / Tract Information

Neighborhood: 507.5
Tract: Section: 25 Township: 27 Range: 03E
Tract Description: S25, T27, R03E, 14905 SQUARE FEET, BEG 30S & 255.44W NE/C NE1/4 S198 W100 N198 E TO POB LESS ROW (SCALED)

Land Based Classification System

Function: Service garage / paint shop / detailing
Activity: Service-oriented shopping
Ownership: Private-fee simple
Site: Developed site - with buildings

Property Factors

Topography:	Level - 1	Parking Type:	Off Street - 1
Utilities:	All Public - 1	Parking Quantity:	Adequate - 2
Access:	Paved Road - 1	Parking Proximity:	On Site - 3
Fronting:	Major Strip or CBD - 1	Parking Covered:	
Location:	Major Strip - 4	Parking Uncovered:	

Appraised Values

Tax Year	Property Class	Land	Building	Total
2023	Commercial & Industrial - C	58,980	42,480	101,460
2022	Commercial & Industrial - C	58,980	40,680	99,660
2021	Commercial & Industrial - C	54,980	38,360	93,340
2020	Commercial & Industrial - C	54,980	38,960	93,940

Market Land Information

Type	Method	Area or Acres	Eff. Frontage	Eff. Depth	Est. Value
Regular Lot - 1	Sqft	0.30			00
Influence #1:		Influence #2:		Influence Override:	
Factor:		Factor:		Depth Factor:	

Residential Information [Information Not Available]

Residential Information [Information Not Available]

Commercial Information

Building #: 1

Building Information

LBCS Structure Code:
Automobile repair and service structures
Building Name: CAR SOLUTIONS
Identical Units: 1
of Units:
Unit Type:
MS Mult:
MS Zip Code:

Apartment Information

Units BR Type Baths

Apartment #1:
Apartment #2:
Apartment #3:
Apartment #4:
Apartment #5:
Apartment #6:
Apartment #7:
Apartment #8:

[View Sketch Vector](#)

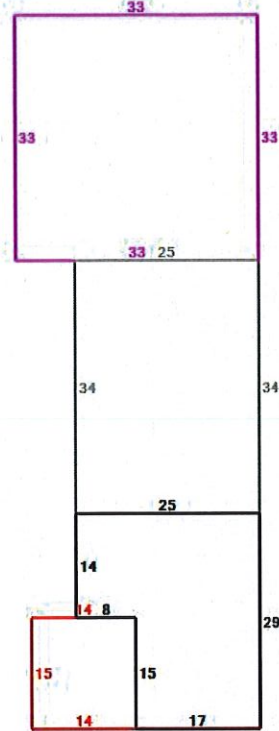

Black = Original
Gray = Addition 1
Red = Addition 2
Fuchsia = Addition 3

Building Sections & Basements

#	Occup	Class	Rank	MS	Year Effective	Build	Year	Levels	Stories	Area	Perim	Hgt	Cond	Func	Econ	%	Ovr Reason	Ovr Use	Depr Class	RC	NG	MS Good	Value	
1	Service Repair Garage	FR	1954	01 / 01	605	60	8	FR	FR					Auto Parts/Service & Industrial - 047	Commercial	30,862	15	4,630						
Section Components																								
	Code	Code Description		Unit Type	Units	Pct %	Other Rank	Year	Comment															
	812			Concrete Block				100																
	649			No HVAC																				
2	Service Repair Garage	FR	1954	01 / 01	850	68	14	FR	FR					Auto Parts/Service & Industrial - 047	Commercial	48,392	15	7,260						
Section Components																								
	Code	Code Description		Unit Type	Units	Pct %	Other Rank	Year	Comment															
	812			Concrete Block				100																
	606			Space Heater				100																
3	Service Repair Garage	FR	1954	01 / 01	210	35	8	FR	FR					Auto Parts/Service & Industrial - 047	Commercial	11,809	14	1,650						
Section Components																								
	Code	Code Description		Unit Type	Units	Pct %	Other Rank	Year	Comment															
	887			Stud -Hardboard Siding				100																
	649			No HVAC																				
4	Service Repair Garage	FR	2005	01 / 01	1,089	107	13	AV	AV					Auto Parts/Service & Industrial - 047	Commercial	53,996	50	27,000						
Section Components																								
	Code	Code Description		Unit Type	Units	Pct %	Other Rank	Year	Comment															
	916			Single -Metal on Steel Frame				100																
	649			No HVAC																				
	8002			Porch, Open Slab				18																

Other Building Improvement Information ✕

Occup	MS Class	Rank	Quantity	Year Effective		LBCS	Area	Perim	Hgt	Dimensions		Stories	Phys Cond		Func	Econ	Ovr %	RCN		MS Value	
				Built	Year					(L x W)	Area		Area	Other				Reason	LD		% Good
Tool Shed	C	AV	1	1954		440	84	8	22 x 20	1	FR	AV					16245	4	650		
Components																					
Code	Code Description										Units	Percentage %	Area	Other	Rank	Year					
649																					
812											100										
Site Improvements	B	AV	1	1954		10		8		1	FR	FR					11269	11	1240		
Components																					
Code	Code Description										Units	Percentage %	Area	Other	Rank	Year					
8355											1,783										
Tool Shed	C	AV	1	1954		16	16	6	4 x 4	1	FR	AV					1260	4	50		
Components																					
Code	Code Description										Units	Percentage %	Area	Other	Rank	Year					
649																					
812											100										

Agricultural Information [Information Not Available] ✕

This parcel record was last updated on 3/7/2023 at 6 am.

PROPERTY TAX INFORMATION



[Return To County Website](#) [Logout](#)

Current Tax Information

Type **CAMA Number** **Tax Identification**
 RL 307 25 0 00 00 002 00 0 01 139-261000

Owner ID SUDD00002SUDDUTH, JACKIE W & ROSE M

Taxpayer ID SUDD00002SUDDUTH, JACKIE W & ROSE M
 11063 SW HWY 54 67010

Subdivision **Block** **Lot(s)** **Section25** **Township27** **Range 03**

[Tax History](#)
[Current Real Estate Detail](#)
[GIS Map](#)
[Print Friendly Version](#)

Year	Statement #	Line #	Warrant #	Specials Description	Specials Payoff	1st Half Due	2nd Half Due	Total Due*	1st Half Paid	2nd Half Paid
<u>2022</u>	0036922	001			0.00	1,689.65	1,689.65	1,689.65	Yes	No

Click on underlined tax year to see payment detail and where the tax dollars go.

* - Does not include all interest, penalties and fees.

For delinquent tax pay off amount contact Butler County Treasurer 205 W. Central Ave, El Dorado, KS 67042, (316) 322-4210

Real Estate Information



This database was last updated on 3/6/2023 at 8:08 PM

[Return to County Website](#) | [Log Out](#)

Parcel Details for 008-307-25-0-00-003.00-0 - Printer Friendly Version

Owner Information <input type="button" value="✕"/>	
Owner's Name (Primary):	SUDDUTH, JACKIE W & ROSE M & SUDDUTH, ALLAN L & SHARON
Mailing Address:	204 W Murdock St Andover, KS 67002-9748
Property Address <input type="button" value="✕"/>	
Address:	11073 SW Highway 54 Augusta, KS 67010
General Property Information <input type="button" value="✕"/>	
Property Class:	Residential - R
Living Units:	2
Zoning:	
Neighborhood:	008.0
Taxing Unit:	139
Deed Information <input type="button" value="✕"/>	
Document #	Document Link
0727-0180	View Deed Information
0727-0179	View Deed Information
0726-0154	View Deed Information
0653-0684	View Deed Information

Neighborhood / Tract Information ✕

Neighborhood: 008.0
Tract: Section: 25 Township: 27 Range: 03E
Tract Description: S25, T27, R03E, BEG 30S & 353.5W NE/C NE1/4 S198 W110 N198 E110 TO POB LESS ROW (SCALED)

Land Based Classification System ✕

Function: Single family residence (detached)
Activity: Household activities
Ownership: Private-fee simple
Site: Developed site - with buildings

Property Factors ✕

Topography:	Level - 1	Parking Type:	On and Off Street - 3
Utilities:	Well - 5; Septic - 6; Gas - 7	Parking Quantity:	Adequate - 2
Access:	Paved Road - 1	Parking Proximity:	On Site - 3
Fronting:	Major Strip or CBD - 1	Parking Covered:	
Location:	Neighborhood or Spot - 6	Parking Uncovered:	

Appraised Values ✕

Tax Year	Property Class	Land	Building	Total
2023	Residential - R	35,200	85,000	120,200
2022	Residential - R	27,400	70,100	97,500
2021	Residential - R	22,900	63,300	86,200
2020	Residential - R	22,200	63,700	85,900

Market Land Information ✕

Type	Method	Area or Acres	Eff. Frontage	Eff. Depth	Est. Value
Regular Lot - 1	Acre	0.40			17,600
Influence #1:		Influence #2:		Influence Override:	
Factor:		Factor:		Depth Factor:	
Regular Lot - 1	Acre	0.40			17,600
Influence #1:		Influence #2:		Influence Override:	
Factor:		Factor:		Depth Factor:	



Building #: 1

Dwelling Information

Residence Type: Residential/Agricultural - 1
 Quality: FR
 Year Built: 1920
 Effective Year:
 MS Style: 5
 LBCS Structure: Detached SFR unit
 # of Units:
 Total Living Area:
 Calculated Area: 1,152
 Main Floor LA: 960
 Upper Floor LA %: 20.0
 CDU: FR
 Phys / Func / Econ: FR / N/A / N/A
 Ovr % Good / RCN: /
 Remodel:
 % Complete:
 Assessment Class:
 MU Class #1 / %: / MU Class #2 / %: / MU Class #3 / %: /

Component Sales Information

Architectural Style: Old Style
 Basement Type: Crawl - 2
 Total Rooms: 5
 Bedrooms: 3
 Family Rooms:
 Full Baths: 1
 Half Baths:
 Garage Capacity:
 Foundation: Block - 3

Residential Components

Code / Description	Units	Percentage	Quality	Year
Enclosed Porch, Solid Walls	288			
Wood Deck with Roof	140			
Frame, Siding/Shingle		100		
Composition Shingle		100		
Raised Subfloor	1,152			
Warmed & Cooled Air		100		
Plumbing Fixtures	5			
Plumbing Rough-ins	1			
Automatic Floor Cover Allowance				
Raised Slab Porch	75		AV	1940

Building #: 2

Dwelling Information

Residence Type: Residential/Agricultural - 1
 Quality: FR
 Year Built: 1920
 Effective Year:
 MS Style: 1
 LBCS Structure: Detached SFR unit
 # of Units:
 Total Living Area:
 Calculated Area: 497
 Main Floor LA: 497
 Upper Floor LA %:
 CDU: PR
 Phys / Func / Econ: FR / N/A / N/A
 Ovr % Good / RCN: /
 Remodel:
 % Complete:
 Assessment Class:
 MU Class #1 / %: / MU Class #2 / %: / MU Class #3 / %: /

Component Sales Information

Architectural Style: Cottage
 Basement Type: Crawl - 2
 Total Rooms: 3
 Bedrooms: 1
 Family Rooms:
 Full Baths: 1
 Half Baths:
 Garage Capacity:
 Foundation: Block - 3

Residential Components

Code / Description	Units	Percentage	Quality	Year
Frame, Siding, Wood		100		
Composition Shingle		100		
Raised Subfloor	497			
Plumbing Fixtures	5			
Plumbing Rough-ins	1			
Automatic Floor Cover Allowance				
Forced Air Furnace		100		
Enclosed Wood Deck, Solid Wall	25			
Wood Deck	20			2002
Wood Deck	16			1990

Building #: 1 Sketch Vector

