

<https://msc.fema.gov/>



Geographic Information Services  
 Sedgwick County...  
 working for you

Date: 3/27/2023

It is understood that the Sedgwick County GIS, Division of Information and Operations, has no indication or reason to believe that there are inaccuracies in information incorporated in the base map.

The GIS personnel make no warranty or representation, either expressed or implied, with respect to the information or the data displayed.

© 2023 Sedgwick County Kansas Government.  
 All rights reserved.

### My Map

Sedgwick County, Kansas



1:2,257

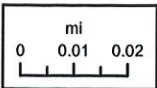

# Viewer Map

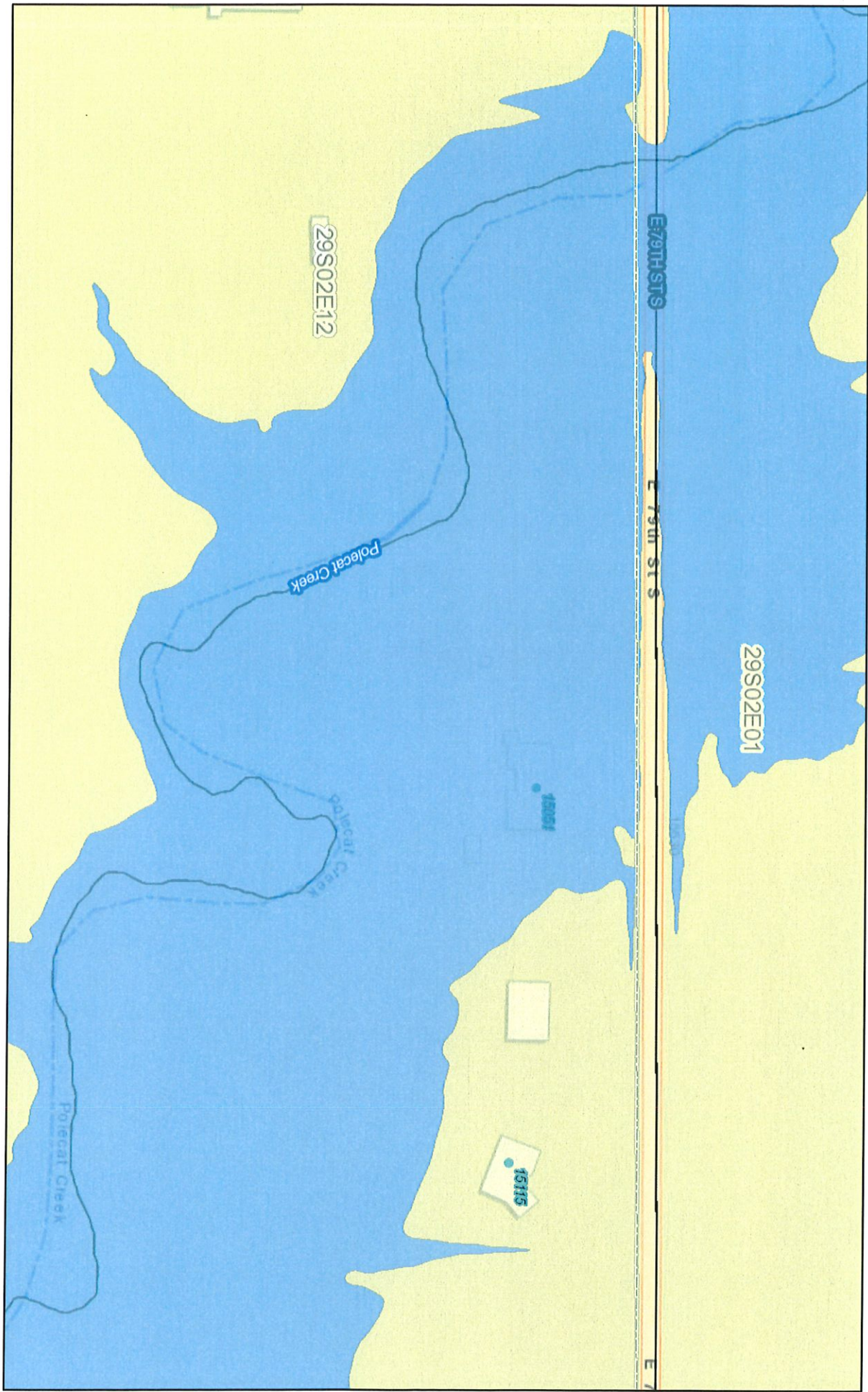

March 27, 2023

- Special Flood Hazard Area**
- AO
  - AH
  - AE, FLOODWAY
  - AE
  - A
  - LOMR Areas
  - Unlettered, Mapped Cross Sections
  - Lettered Cross Sections
  - Base Flood Elevations
  - Streams
  - Profile Baseline



All Kansas PSAPs, NCG911 Coordinating Council, DASC, City of Wichita, Sedgewick County, Esri, HERE, Garmin, INCREMENT P, NGA, USGS  
 Base Flood Approximate Elevations developed by Kansas Department of  
 Copyright 2014