







This database was last updated on 4/26/2023 at 8:07 PM

[Return to County Website](#) | [Log Out](#)

Parcel Details for 008-415-16-0-30-02-001.00-0 - Printer Friendly Version

Owner Information 	
Owner's Name (Primary):	BORN, GARY A
Mailing Address:	601 N HWY 77 DOUGLASS, KS 67039-8623
Property Address 	
Address:	601 N Highway 77 Douglass, KS 67039
General Property Information 	
Property Class:	Farm Homesite - F
Living Units:	1
Zoning:	
Neighborhood:	012.0
Taxing Unit:	238
Deed Information 	
Document #	Document Link
2022-8826	View Deed Information
0740-0065	View Deed Information
D312-0432	View Deed Information

Neighborhood / Tract Information ✕

Neighborhood: 012.0
Tract: Section: 16 Township: 29 Range: 04E
Tract Description: S16 , T29 , R04E , ACRES 16.8 , NE/4 SW/4 LYING W HWY 77 EXC BEG SW/C NE/4 N703.6 SELY747.2 ALG DITCH SE112.3 SLY25 ALG HWY ROW W470.5 TO POB

Land Based Classification System ✕

Function: Farming / ranch operation (with improvements)
Activity: Farming, plowing, tilling, harvesting, or related activities
Ownership: Private-fee simple
Site: Dev Site - crops, grazing etc - with structures

Property Factors ✕

Topography:	Level - 1; Rolling - 4	Parking Type:	On and Off Street - 3
Utilities:	Well - 5; Septic - 6	Parking Quantity:	Adequate - 2
Access:	Paved Road - 1	Parking Proximity:	On Site - 3
Fronting:	Major Strip or CBD - 1	Parking Covered:	
Location:	Neighborhood or Spot - 6	Parking Uncovered:	

Appraised Values ✕

Tax Year	Property Class	Land	Building	Total
2023	Farm Homesite - F	33,400	61,710	95,110
2023	Agricultural Use - A	6,380	4,960	11,340
2022	Farm Homesite - F	20,800	55,930	76,730
2022	Agricultural Use - A	6,460	4,500	10,960
2021	Farm Homesite - F	16,700	52,600	69,300
2021	Agricultural Use - A	6,240	3,560	9,800
2020	Farm Homesite - F	16,100	48,600	64,700
2020	Agricultural Use - A	6,030	3,960	9,990

Market Land Information ✕

Type	Method	Area or Acres	Eff. Frontage	Eff. Depth	Est. Value
Regular Lot - 1	Acre	1.20			00
Influence #1:		Influence #2:	Influence Override:		
Factor:		Factor:	Depth Factor:		

Physical Information



Building #: 1

Dwelling Information

Residence Type: Residential/Agricultural - 1
 Quality: AV-
 Year Built: 1976
 Effective Year:
 MS Style: 1
 LBCS Structure: Detached SFR unit
 # of Units:
 Total Living Area:
 Calculated Area: 864
 Main Floor LA: 864
 Upper Floor LA %:
 CDU: FR
 Phys / Func / Econ: FR / N/A / N/A
 Ovr % Good / RCN: /
 Remodel:
 % Complete:
 Assessment Class:
 MU Class #1 / %: / MU Class #2 / %: / MU Class #3 / %: /

Component Sales Information

Architectural Style: Ranchette
 Basement Type: Slab - 1
 Total Rooms: 4
 Bedrooms: 2
 Family Rooms:
 Full Baths: 1
 Half Baths: 1
 Garage Capacity:
 Foundation: None - 1

Residential Components

Code / Description	Units	Percentage	Quality	Year
Frame, Hardboard Sheets		100		
Composition Shingle		100		
Slab on Grade	864			
Warmed & Cooled Air		100		
Plumbing Fixtures	7			
Plumbing Rough-ins	1			
Single 1-Story Fireplace	1			
Automatic Floor Cover Allowance				
Open Slab Porch	144			1976
Open Slab Porch	432			1976

Physical Information

Building #: 1 Sketch Vector

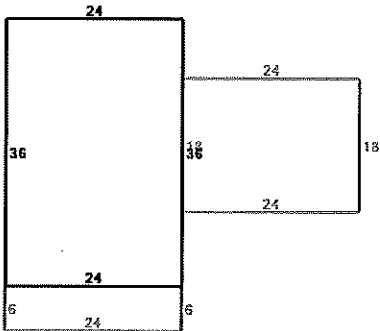

- Black** = Original
- Gray** = Open Slab Porch (SF) 1
- Red** = Open Slab Porch (SF) 2

Geographic Information [Information Not Available]



Other Building Improvement Information



Occup	MS Class	Rank	Quantity	Year Built	Effective Year	LBCS	Area	Perim	Hgt	Dimensions (L x W)	Stories	Phys Cond	Func	Econ	Ovr %	Reason	RCN LD	% Good	MS Value
Farm Utility Building	P	AV	1	2009			1170	138	10	39 x 30	1	AV	AV			16157	30	4850	
Components																			
Code	Code Description			Units	Percentage %	Area	Other	Rank	Year										
918					100														
649																			
Loafing Shed	P	AV	1	1997			120	32	8	12 x 10	1	AV	AV			1272	9	110	
Components																			
Code	Code Description			Units	Percentage %	Area	Other	Rank	Year										
918					100														
649																			
Residential Garage - Detached	D	AV	1	1976			416	84	8	26 x 16	1	AV	AV			23976	17	4080	
Components																			
Code	Code Description			Units	Percentage %	Area	Other	Rank	Year										

8090							390									
8015							132									
Prefabricated Storage Shed	D	AV	1	1995	120	44	8	12 x 10	1	AV	AV	2927	7	200		
Components																
Code	Code Description					Units	Percentage %			Area	Other	Rank	Year			
Prefabricated Storage Shed	D	AV	1	2021	64	32	7	8 x 8	1	AV	AV	1822	41	750		
Components																
Code	Code Description					Units	Percentage %			Area	Other	Rank	Year			

Agricultural Information																
Agricultural Land																
Land Type:	Dry Land - DR	Irrig. Type:		Adjust Code:		Use Value:	4,440									
Acres:	11.30	Well Depth:		Govt. Prgm:		Market Value:	59,980									
Soil Unit:	3890	Acre Feet:		Base Rate:	393											
		Acre Feet/Ac:		Adjust Rate:	393											
Land Type:	Dry Land - DR	Irrig. Type:		Adjust Code:		Use Value:	1,940									
Acres:	4.30	Well Depth:		Govt. Prgm:		Market Value:	25,830									
Soil Unit:	6220	Acre Feet:		Base Rate:	450											
		Acre Feet/Ac:		Adjust Rate:	450											
Agricultural Land Summary																
Dry Land - DR Acres:	15.60			Total Land Acres:	15.60											
				Total Land Use Value:	6,380											
				Total Land Mkt Value:	85,810											

This parcel record was last updated on 4/27/2023 at 6 am.

PROPERTY TAX INFORMATION



[Return To County Website](#) [Logout](#)

Current Tax Information

Type CAMA Number Tax Identification
 RL 415 16 0 30 02 001 00 0 01 238-148000
 Owner ID BORN00011BORN, GARY A
 Taxpayer ID CORE00007CORELOGIC TAX SERVICES ATTN: ESCROW REPORTING
 601 N HWY 77 67039
 Subdivision Block Lot(s) Section 16 Township 29 Range 04

[Tax History](#)
[Current Real Estate Detail](#)
[GIS Map](#)
[Print Friendly Version](#)

Year	Statement #	Line #	Warrant #	Specials Description	Specials Payoff	1st Half Due	2nd Half Due	Total Due*	1st Half Paid	2nd Half Paid
<u>2022</u>	0042508	001			0.00	794.20	794.20	794.20	Yes	No

Click on underlined tax year to see payment detail and where the tax dollars go.

* - Does not include all interest, penalties and fees.

For delinquent tax pay off amount contact Butler County Treasurer 205 W. Central Ave, El Dorado, KS 67042, (316) 322-4210