

# Real Estate Information



This database was last updated on 12/17/2023 at 8:05 PM

[Return to County Website](#) | [Log Out](#)

## Parcel Details for 008-295-22-0-10-02-008.00-0 - Printer Friendly Version

Owner Information <span style="float: right;">⊗</span>	
<b>Owner's Name (Primary):</b>	SOWELL, KEITH R
<b>Mailing Address:</b>	311 E Clark Ave Augusta, KS 67010-1513
Property Address <span style="float: right;">⊗</span>	
<b>Address:</b>	1707 N Moyle St Augusta, KS 67010
General Property Information <span style="float: right;">⊗</span>	
<b>Property Class:</b>	Residential - R
<b>Living Units:</b>	1
<b>Zoning:</b>	
<b>Neighborhood:</b>	241
<b>Taxing Unit:</b>	002
Deed Information <span style="float: right;">⊗</span>	
<b>Document #</b>	<b>Document Link</b>
2019-1574	<a href="#">View Deed Information</a>
0872-0053	<a href="#">View Deed Information</a>
0630-0605	<a href="#">View Deed Information</a>
D398-0457	<a href="#">View Deed Information</a>
D202-0462	<a href="#">View Deed Information</a>

Neighborhood / Tract Information	
<b>Neighborhood:</b>	241 Block: F Lot: 12; 13; 14
<b>Tract:</b>	Section: 22 Township: 27 Range: 04E
<b>Tract Description:</b>	MOYLE, JOHN W, ADD, S22, T27, R04E, BLOCK F, Lot 12; 13; 14

Land Based Classification System	
<b>Function:</b>	Single family residence (detached)
<b>Activity:</b>	Household activities
<b>Ownership:</b>	Private-fee simple
<b>Site:</b>	Developed site - with buildings

Property Factors			
<b>Topography:</b>	Level - 1	<b>Parking Type:</b>	On and Off Street - 3
<b>Utilities:</b>	All Public - 1	<b>Parking Quantity:</b>	Adequate - 2
<b>Access:</b>	Paved Road - 1; Alley - 7	<b>Parking Proximity:</b>	On Site - 3
<b>Fronting:</b>	Residential Street - 4	<b>Parking Covered:</b>	
<b>Location:</b>	Neighborhood or Spot - 6	<b>Parking Uncovered:</b>	

Appraised Values				
Tax Year	Property Class	Land	Building	Total
2023	Residential - R	12,850	83,350	96,200
2022	Residential - R	12,850	74,750	87,600
2021	Residential - R	12,850	64,350	77,200
2020	Residential - R	12,850	61,450	74,300

Market Land Information					
Type	Method	Area or Acres	Eff. Frontage	Eff. Depth	Est. Value
Regular Lot - 1	Sqft	9750.00			00
<b>Influence #1:</b>		<b>Influence #2:</b>		<b>Influence Override:</b>	
<b>Factor:</b>		<b>Factor:</b>		<b>Depth Factor:</b>	

Residential Information ✖

**Building #: 1**

**Dwelling Information**

Residence Type: Residential/Agricultural - 1  
 Quality: AV-  
 Year Built: 1948  
 Effective Year:  
 MS Style: 1  
 LBCS Structure: Detached SFR unit  
 # of Units:  
 Total Living Area:  
 Calculated Area: 1,158  
 Main Floor LA: 1,158  
 Upper Floor LA %:  
 CDU: AV-  
 Phys / Func / Econ: AV- / N/A / N/A  
 Ovr % Good / RCN: /  
 Remodel:  
 % Complete:  
 Assessment Class:  
 MU Class #1 / %: / MU Class #2 / %: / MU Class #3 / %: /

**Component Sales Information**

Architectural Style: Ranch  
 Basement Type: Crawl - 2  
 Total Rooms: 4  
 Bedrooms: 2  
 Family Rooms:  
 Full Baths: 1  
 Half Baths:  
 Garage Capacity:  
 Foundation: Concrete - 2

**Residential Components**

Code / Description	Units	Percentage	Quality	Year
Wood Deck	264			1998
Attached Garage	252			
Frame, Siding/Shingle		100		
Composition Shingle		100		
Raised Subfloor	1,158			
Warmed & Cooled Air		100		
Plumbing Fixtures	6			
Plumbing Rough-ins	1			
Automatic Floor Cover Allowance				
Wood Deck	36			
Wood Deck with Roof	54			

Residential Information ✖

**Building #: 1 Sketch Vector**

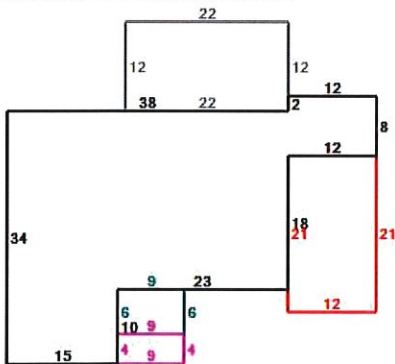

- Black** = Original
- Gray** = Wood Deck (SF) 1
- Red** = Attached Garage (SF) 2
- Fuchsia** = Wood Deck (SF) 3
- Teal** = Wood Deck (SF) with Roof 4

Commercial Information [Information Not Available] ✖

Other Building Improvement Information ✖

Occup	MS Class	Rank	Quantity	Year Effective		Dimensions				Phys Cond	Econ	Ovr %	Reason	RCN LD	% Good	MS Value
				Built	Year	LBCS	Area	Perim	Hgt							
Prefabricated Storage Shed	D	AV	1	1996		120	44	10	12 x 10	1	AV	AV		3040	7	210

Code	Description	Units	Percentage %	Area	Other	Rank	Year

Agricultural Information [Information Not Available] ✖

This parcel record was last updated on 12/18/2023 at 6 am.